



1313 MOCKING BIRD LANE

Arson Investigation



The Call

Date March 12, 2017

Time 10 PM

Run District: Advanced Fire Department

Initial Dispatch: Alarm system

Actual type: Dwelling

Companies responding: E-1, E-2, L-1, DC-4

Side A



Fire was reported in the kitchen located in the center of the house

Rescue was made from 2nd floor bed room side A

Layout of 1st Floor

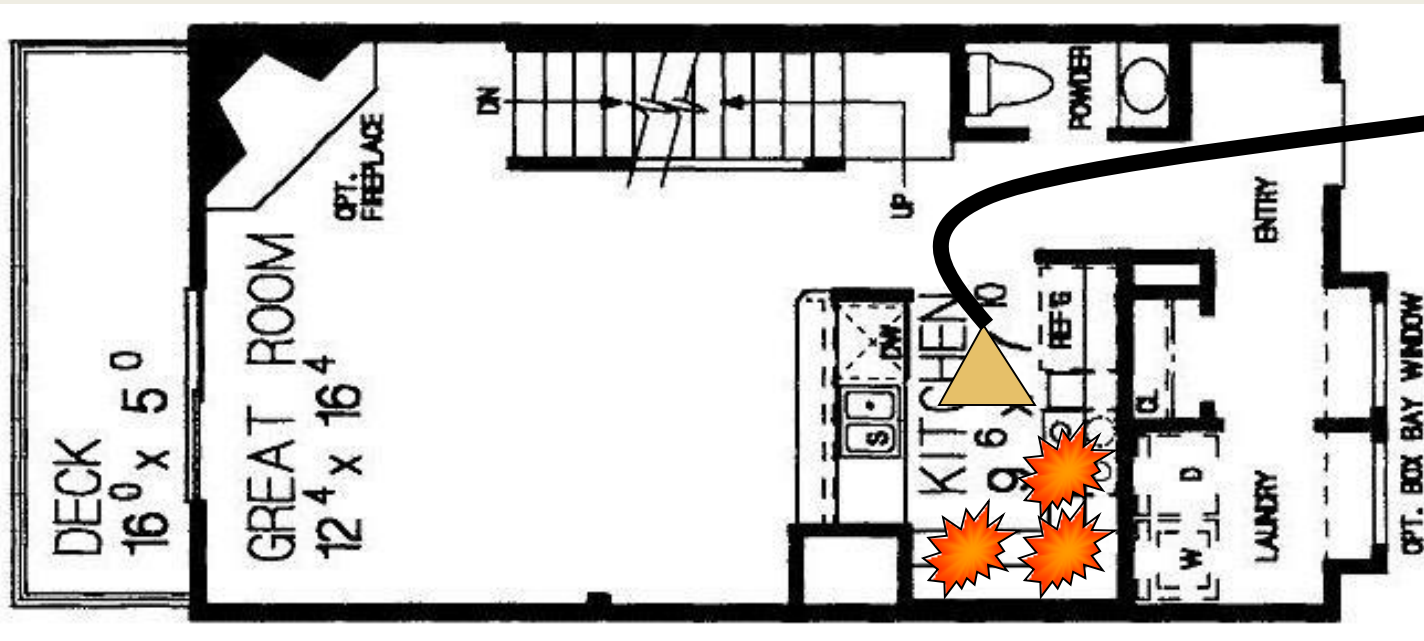

E-1

Layout of 2nd Floor

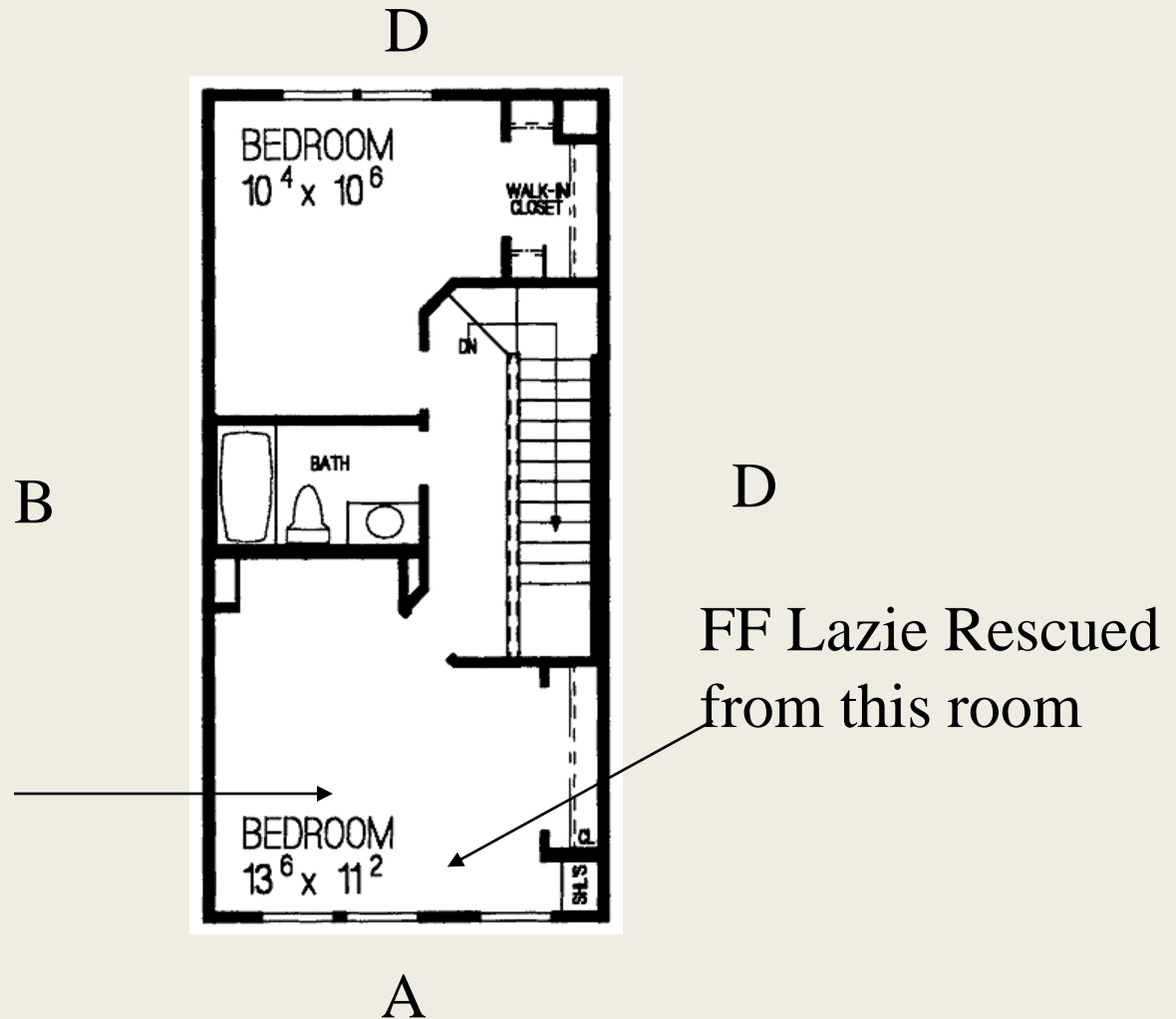

Victim rescued from this room

FF Lazie Rescued from this room

The Response Data

This report will
give you a good
time-line to
begin your
investigation

Advanced Fire Department
To protect and serve



Response Print Out

ALARM TIME: 21:56

LOCATION: 1313 MOCKING BIRD LINE

FIREBOX: 04-01

EMS BOX: 186-01

CALLER: ETHEL MERTZ 1320 MOCKING BIRD LANE

PHONE 215-555-1234

REPORT: CALLER STATES THAT THE SMOKE DETECTOR IS SOUNDING AT 1313 MOCKING BIRD LANE. NOTHING FURTHER

CO. DUE: E-1 (AFD)

CALL HISTORY

2157: E-1 RESPONDING

2158: SECOND CALLER MRS. SMITH REPORTS SMELL OF SMOKE 1300 BLOCK MOCKING BIRD LANE

2159: E-1 ON LOCATION ... REPORTS HEAVY SMOKE SHOWING CO. IN SERVICE UP GRADE

2200: E-2, L-3, and DC 4.... RESPOND 1313 MOCKING BIRD LANE, DWELLING

2202: E-1 REPORTS POSSIBLE ENTRAPMENT 2ND FLOOR

2205: E-1 REPORTS FIRE FIGHTER LOST, COMPANIES EVACUATING

2206: E-1 REPORTS CONFIRMS 1 ENTRAPPED MAKING RESCUE SIDE A, EMS TO SCENE

2207: E-2 ON LOCATION ASSISTING E-1

2208: L-3, DC 4 ON LOCATION

2209: DC 4 REPORTS FIRE UNDER CONTROL 2ND EMS UNIT TO SCENE

2210: DC 4 REQUESTS FM 5 TO SCENE

2211: DC 4 REPORT EMS TRANSPORTING TWO TO HOSPITAL FOR BURNS

2225: COMPANIES MOPPING-UP

2235: E-2, L-3 AVAILABLE

2240: E-1, DC 4 AWAITING FM 5, E-1. O.O.S.

2245: FM 5 ON SCENE

2305: FM 5 EN-ROUTE TO HOSPITAL TO TALK TO VICTIMS, ALSO REQUEST TO CONFIRM ALL CALLERS, ONLY 2 CALLS RECEIVED

2306: DC 4 REPORTS E-1 RETURNING TO STATION STILL O.O.S

2307: CALL CLEARED

Statements

FF Gerous: stated the front door was locked from the inside. He and FF Younger made forced entry to front door. They encountered dense smoke and high heat levels as they worked their way down the hall wall near the stairs. To the left of the stairs they saw the fire and proceeded to extinguish it.

Statements

FF Younger: stated the same as above but added they had to back out of the building when they heard the “ALL OUT” signal. When they got out they saw FF Oldmen coming down the steps without FF Lazie. When they got out they saw FF Lazie at the window holding a child. FF Gerous carried down the child and she started working on her, she did notice the child had burns to the hand and arms and her hair was shinged.

Statements

FF Oldmen: stated he and FF Lazie were searching the second floor when FF Lazie stated he was getting burned and he sounded the “ALL OUT” signal, the rest of his statement was the same as FF Younger.

FF Stable: stated that a woman (Mrs. Ima D. Smith) ran down the street and told him that her daughter was still in the house. He radioed this information to the inside crew. He also added that Mrs Smith said that she had been visiting a friend up the street at the time of the fire.

Statements

Mrs. Ima D. Smith: stated to the investigator that she was at home at the time of the fire and that she ran out of the house and up the street to a friends house to call the fire department (a Mr. Cause), she thought her daughter was following her. When asked how she thought the fire might have started she said she was using the burners on the stove to heat her house since the heater was broken.

Statements

Mrs. E Mertz: (1320 Mocking Bird Lane) stated to the investigator that she saw Mrs. Smith leave the house about an hour before the fire and that she heard a smoke detector going off and called the fire department. She also said that while it was none of her business she believed Mrs. Smith to be a bad parent and she wasn't surprised that the little girl tried to burn the house down.

The Fire Room

The fire was located in the kitchen on the stove top and extended into the cabinets, there was heat and smoke damage to both the first and second floors due to the proximity of the stair to the fire.

